

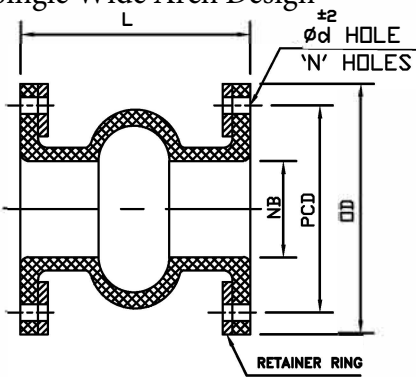

BossFlex Rubber Expansion Joint
Series 100
Single Wide Arch Design

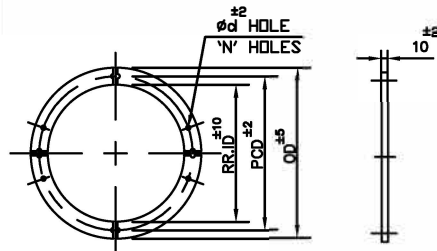

TOLERANCE : AS PER FSA STANDARD



RETAINER RING - ASTM A36 (HOT DIP.GALV.)
SPLIT IN 2 HALVES (25-500NB)
SPLIT IN 4 QUARTERS (600-1200NB)

ITEM NO.	NB		OD		PCD		ød		N	L		RR.ID (In mm)	TEST VACUUM (Hg)	MOVEMENTS AT DESIGN PRESSURE (mm)			MOVEMENTS AT DESIGN PRESSURE (Inch)			PRESSURE PSI (g)	
	(In mm)	(In Inch)	(In mm)	(In Inch)	(In mm)	(In Inch)	(In mm)	(In Inch)		(In mm)	(In Inch)			AXIAL EXPANSION	AXIAL COMPRESSION	LATERAL DEFLECTION	AXIAL EXPANSION	AXIAL COMPRESSION	LATERAL DEFLECTION	DESIGN	*HYDRO TEST
1	25	1	108	4-1/4	78	3-1/8	16	5/8	4	152	6	65	730mm	-	-	-	-	-	-	225	337.5
2	40	1-1/2	127	5	98	3-7/8	16	5/8	4	152	6	80	730mm	19.05	44.45	19.05	3/4	1-3/4	3/4	225	337.5
3	50	2	152	6	121	4-3/4	19	3/4	4	152	6	90	730mm	19.05	44.45	19.05	3/4	1-3/4	3/4	225	337.5
4	65	2-1/2	178	7	140	5-1/2	19	3/4	4	152	6	102	730mm	19.05	44.45	19.05	3/4	1-3/4	3/4	225	337.5
5	80	3	191	7-1/2	152	6	19	3/4	4	152	6	120	730mm	19.05	44.45	19.05	3/4	1-3/4	3/4	225	337.5
6	100	4	229	9	191	7-1/2	19	3/4	8	152	6	146	730mm	19.05	44.45	19.05	3/4	1-3/4	3/4	225	337.5
7	125	5	254	10	216	8-1/2	22	7/8	8	152	6	175	730mm	19.05	44.45	19.05	3/4	1-3/4	3/4	225	337.5
8	150	6	279	11	241	9-1/2	22	7/8	8	152	6	200	730mm	19.05	44.45	25.4	3/4	1-3/4	1	225	337.5
9	200	8	343	13-1/2	298	11-3/4	22	7/8	8	203	6	255	730mm	19.05	44.45	25.4	3/4	1-3/4	1	225	337.5
10	250	10	406	16	362	14-1/4	25	1	12	203	8	310	660mm	19.05	44.45	25.4	3/4	1-3/4	1	225	337.5
11	300	12	483	19	432	17	25	1	12	203	8	370	660mm	19.05	44.45	25.4	3/4	1-3/4	1	225	337.5
12	350	14	533	21	476	18-3/4	29	1-1/8	12	203	8	420	380mm	19.05	44.45	25.4	3/4	1-3/4	1	225	337.5
13	400	16	597	23-1/2	540	21-1/4	29	1-1/8	16	203	8	470	380mm	19.05	44.45	25.4	3/4	1-3/4	1	160	240
14	450	18	635	25	578	22-3/4	32	1-1/4	16	203	8	520	380mm	19.05	44.45	25.4	3/4	1-3/4	1	160	240
15	500	20	699	27-1/2	635	25	32	1-1/4	20	203	8	580	380mm	19.05	44.45	25.4	3/4	1-3/4	1	130	195
16	500	20	699	27-1/2	635	25	32	1-1/4	20	254	10	580	380mm	19.05	44.45	25.4	3/4	1-3/4	1	130	195
17	600	24	813	32	749	29-1/2	35	1-3/8	20	254	10	680	380mm	25.4	44.45	25.4	1	1-3/4	1	130	195
18	650	26	870	34-1/4	806	31-3/4	35	1-3/8	24	254	10	730	380mm	25.4	44.45	25.4	1	1-3/4	1	110	165
19	700	28	927	36-1/2	864	34	35	1-3/8	28	254	10	780	380mm	25.4	44.45	25.4	1	1-3/4	1	110	165
20	750	30	984	38-3/4	914	36	35	1-3/8	28	254	10	830	380mm	25.4	44.45	25.4	1	1-3/4	1	95	143
21	900	36	1168	46	1086	42-3/4	41	1-5/8	32	254	10	980	380mm	25.4	57.15	25.4	1	2-1/4	1	90	135
22	1200	48	1511	58-1/2	1422	56	41	1-5/8	44	304	10	980	380mm	25.4	57.15	25.4	1	2-1/4	1	90	135

*at room temp. for 10 minutes

TECHNICAL:

MATERIAL	EPDM INNER TUBE AND OUTER COVER NEOPRENE INNER TUBE AND OUTER COVER NITRILE INNER TUBE AND NEOPRENE OUTER COVER CHLOROBUTYL INNER TUBE AND OUTER COVER
SHORE HARDNESS	65±5° SH.A
TEMPERATURE	Max. 121°C (EPDM with Nylon fabric) Max. 107°C (Neoprene with Nylon fabric) Max. 99°C (Nitrile with Nylon fabric) Max. 121°C (chlorobutyl with Nylon fabric)
FLOWING MEDIUM	WATER (EPDM, Neoprene & Chlorobutyl) / OIL (Nitrile)
SHORE HARDNESS	65±5° SH.A
DRILLING	ANSI B16.5 CL.150 (25 - 600NB) AWWA C207 CL.D (650 - 1200NB)

2022	NAME	DATE	UIP International, Inc - RUBBER EXPANSION JOINT
DRN	GRACE	18.10	
CHD	T.R	18.10	
APPD	R.B	18.10	
SCALE: NTS			
			REV. 2